

Section A-A  
1:5

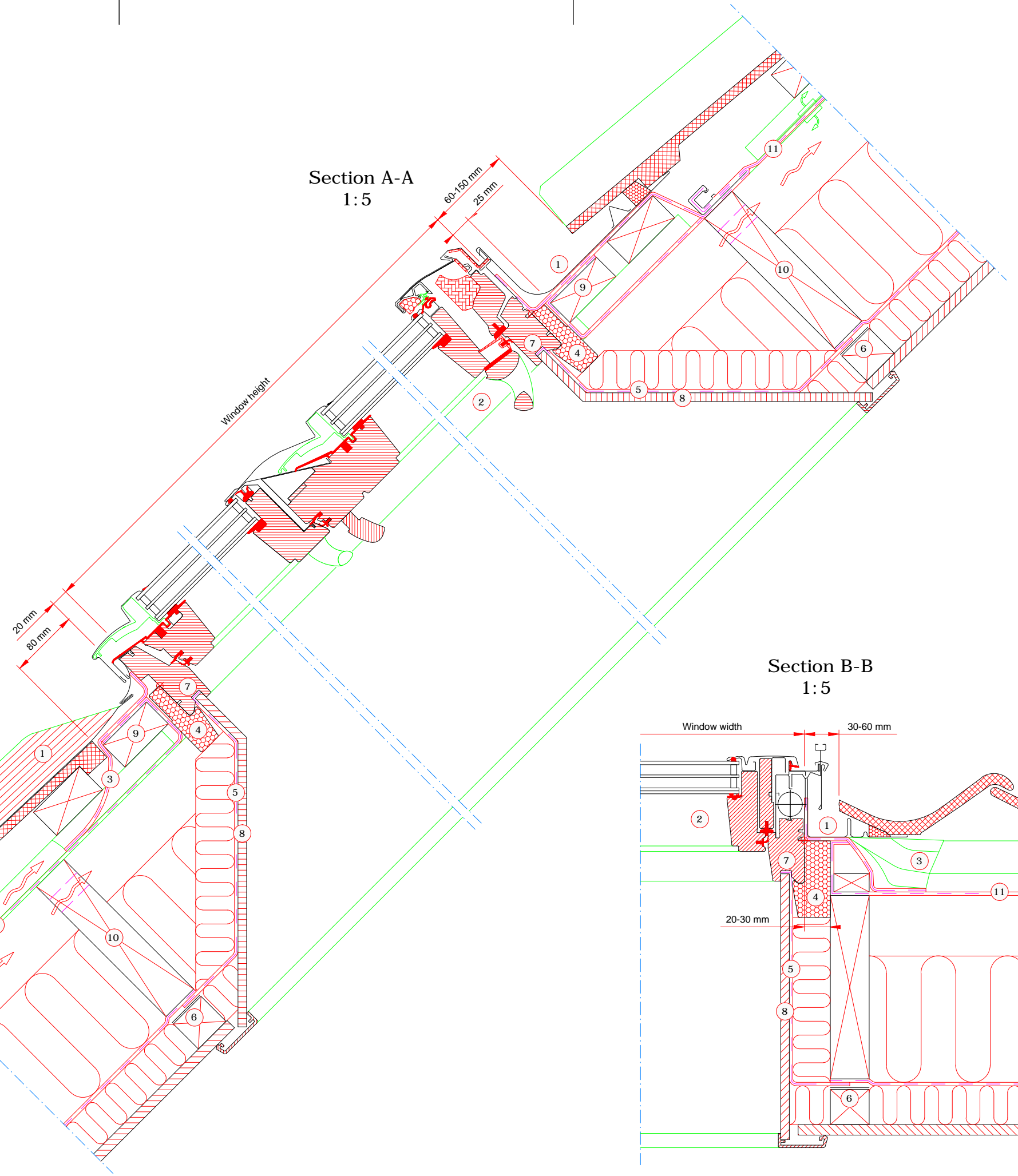

Section B-B  
1:5

- ① VELUX flashing (EDW and ETW 15°-90°)
- ② VELUX window (GDL 35°-53°)
- ③ VELUX underfelt collar (BFX and BFX WK34)
- ④ VELUX insulation frame (BDX and BDX WK34)
- ⑤ VELUX vapour barrier (BBX and BBX WK34)
- ⑥ VELUX vapour barrier tape (BBX)
- ⑦ Gasket on BBX in window rebate
- ⑧ VELUX Lining (LS- and LL-)
- ⑨ Installation batten (Non VELUX)
- ⑩ Trimmer where necessary (Non VELUX)
- ⑪ Felt/breather membrane (Non VELUX)

Roof covering:

Tiles  
Max 120 mm

VELUX Products:

GDL  
35°-53°

EDW  
15°-90°

BFX

BDX

BBX

LS-

ETW  
15°-90°

BFX  
WK34

BDX  
WK34

BBX  
WK34

LL-

VELUX window sizes:

| Size | Width (mm) | Size | Height (mm) |
|------|------------|------|-------------|
| PK-- | 942        | -K19 | 2520        |
| SK-- | 1140       |      |             |

© VELUX GROUP ® VELUX, VELUX logo are registered trademarks



File name: 4\_EDW-GDL-TILES-BALCONY

|                            |            |               |               |
|----------------------------|------------|---------------|---------------|
| Drawing no.:---            |            | SCo:---       |               |
| Create date:<br>19.08.2015 | Rev. date: | Format:<br>A3 | Scale:<br>1:5 |

Note: When installing VELUX Roof Windows, flashings and installation products, the manufacturers instructions and current building and fire regulations, where applicable, must be met.